

# HÄFELE AUTOMATIC OPENING LID STAY

Unhanded design, suitable for wooden and aluminium framed doors.



> Order concealed cup hinges separately, shown from page 65

## Flap stay

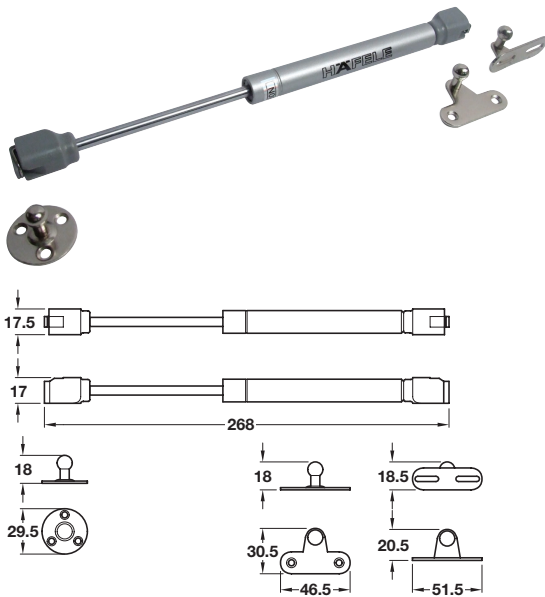

### Installation examples

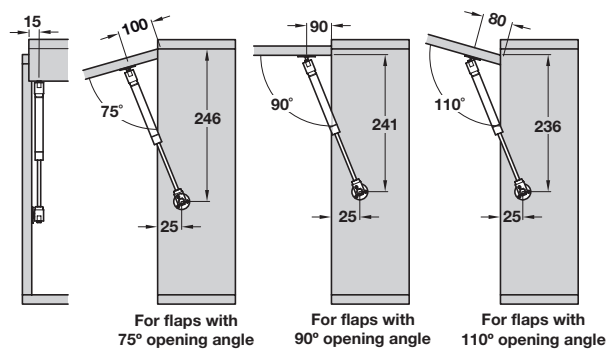

- > Opening angles: 75°, 90° or 110°
- > For pneumatic support
- > Unhanded design
- > Clip-mounting on pre-mounted screw fixing brackets, no tools required
- > Suitable for wooden and aluminium frame doors (choice of bracket supplied)
- > Installation instructions included
- > Silver colour painted and polished chrome-plated lid stay, nickel-plated screw fixing brackets
- > Order qty: 1 pc

### Sample measurements table

| Flap height        | Max flap weight |        |        |
|--------------------|-----------------|--------|--------|
| With opening angle | 75°             | 90°    | 110°   |
| 300 mm             | 2.7 kg          | 2.4 kg | 2.1 kg |
| 400 mm             | 2.0 kg          | 1.8 kg | 1.6 kg |
| 500 mm             | 1.6 kg          | 1.4 kg | 1.2 kg |
| 600 mm             | 1.4 kg          | 1.2 kg | 1.0 kg |

This table applies to one gas-filled lid stay. The load bearing capacity doubles when using 2 gas-filled lid stays. It is recommended to use 2 gas filled lid stays for parallel and synchronized opening action of large lids.



| Model | Cat. No.   |
|-------|------------|
| 60N   | 373.82.001 |
| 80N   | 373.82.002 |
| 100N  | 373.82.003 |
| 120N  | 373.82.004 |
| 150N  | 373.82.005 |